

Location:

Pre-Milling/Joint Trimming

Quantity on Machine:

24 (12 Per Head, Two Heads)

Part Number:

4-014-03-1062

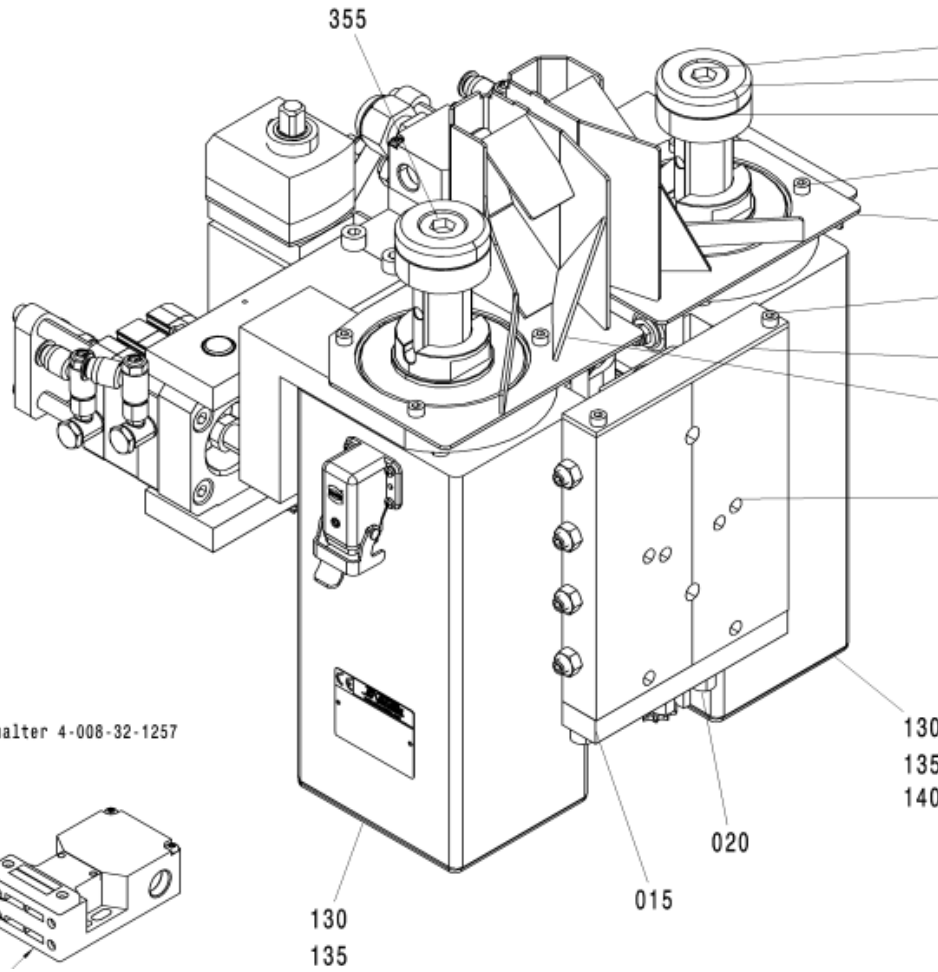

Location: Guillotine/Slipping Scissors
Quantity on Machine: 1
Part Number: 3-602-13-0110

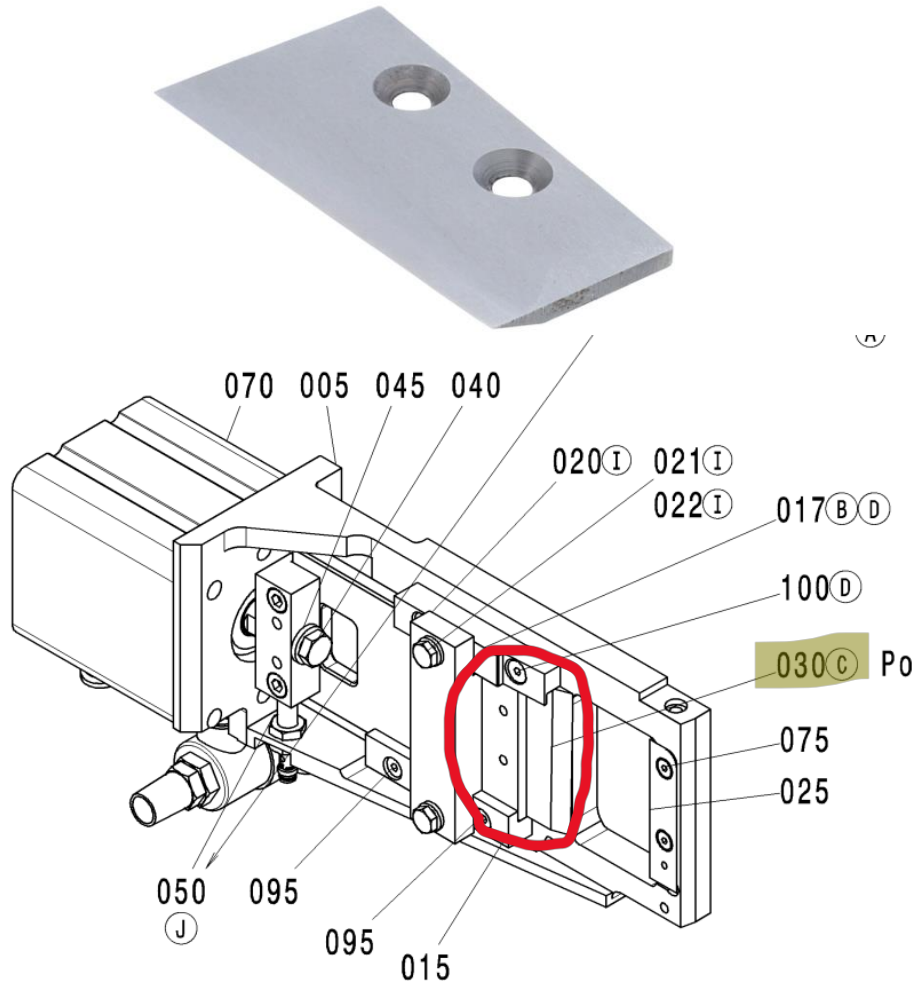

Location: Guillotine/Snipping Scissors
Quantity on Machine: 1
Part Number: 3-602-13-0070

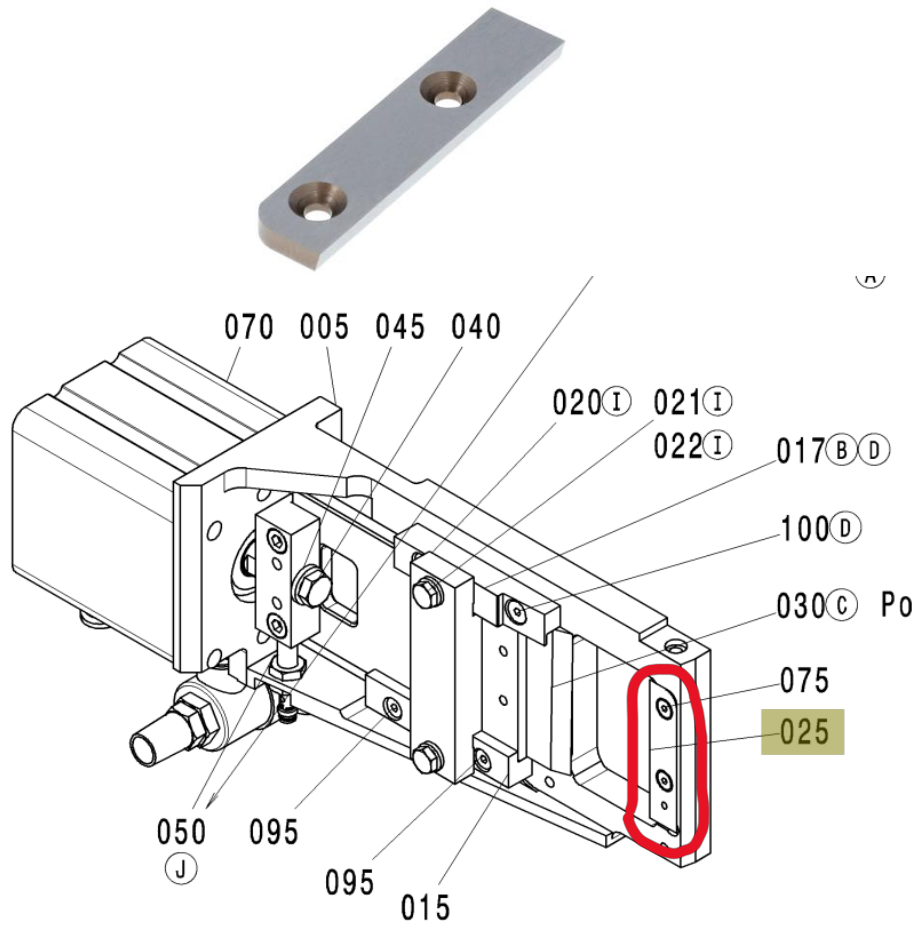

Location: Snipping Unit
Quantity on Machine: 1 of Each Blade
Part Number: 4-014-01-0374 & 4-014-01-0367



Location:
Quantity on Machine:
Part Number:

Trimming Unit
4 of Each Blade (L & R)
Various

4-014-03-0685

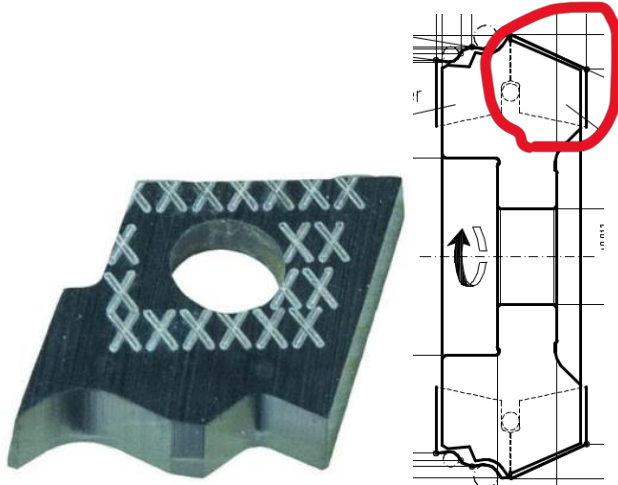

4-014-03-0551

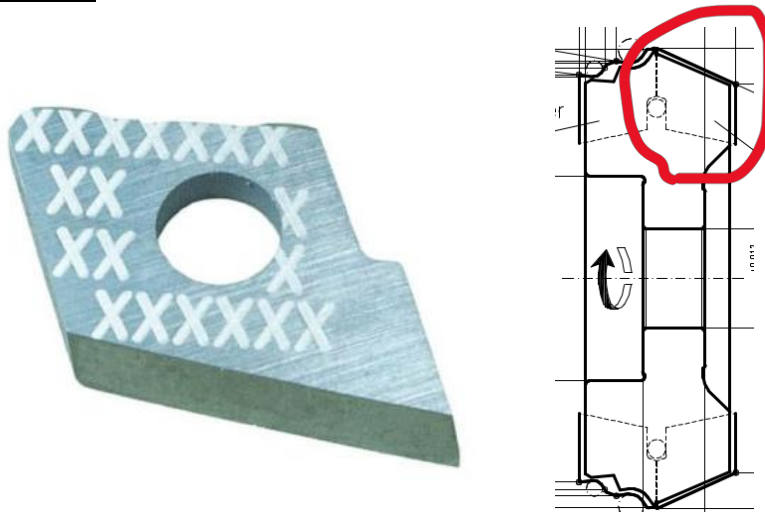

4-014-03-0684

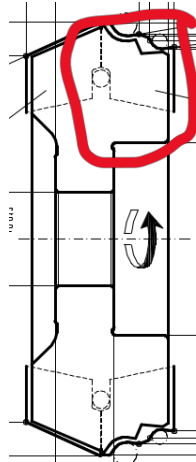
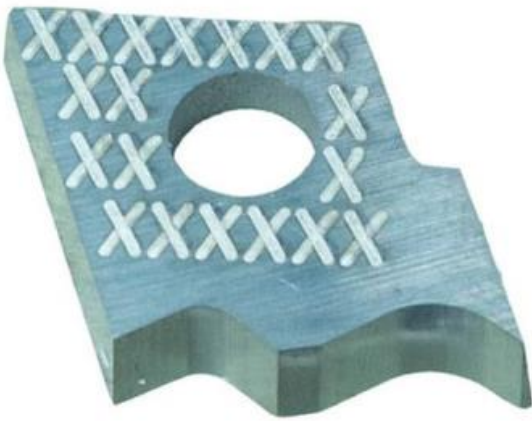

4-014-03-0556

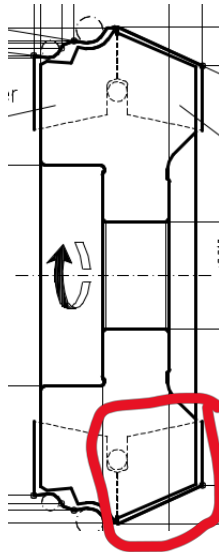
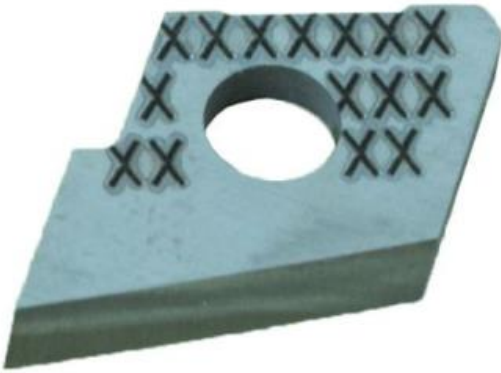

Please Note; There are two different Profile Cutter Heads for the two rotations.

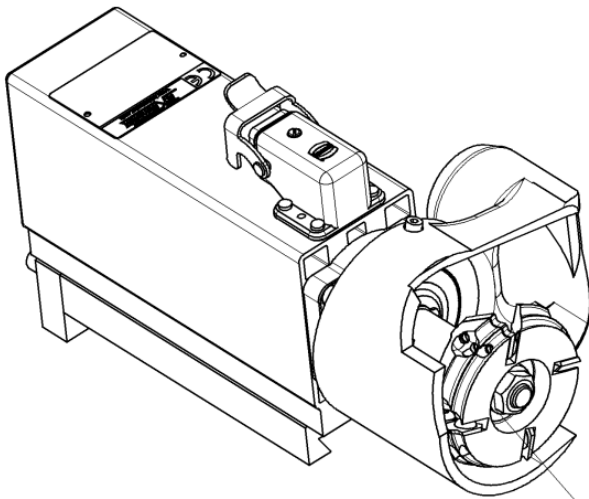

One Cutter Head on Each Motor.

Location: Profile Trimming Unit / Corner Rounding
Quantity on Machine: 1 Radius Cutter Ea / Top/Bottom
Part Number: 4-014-02-2374 & 4-014-02-2380

4-014-02-2374 – Right Hand



4-014-02-2380 – Left Hand



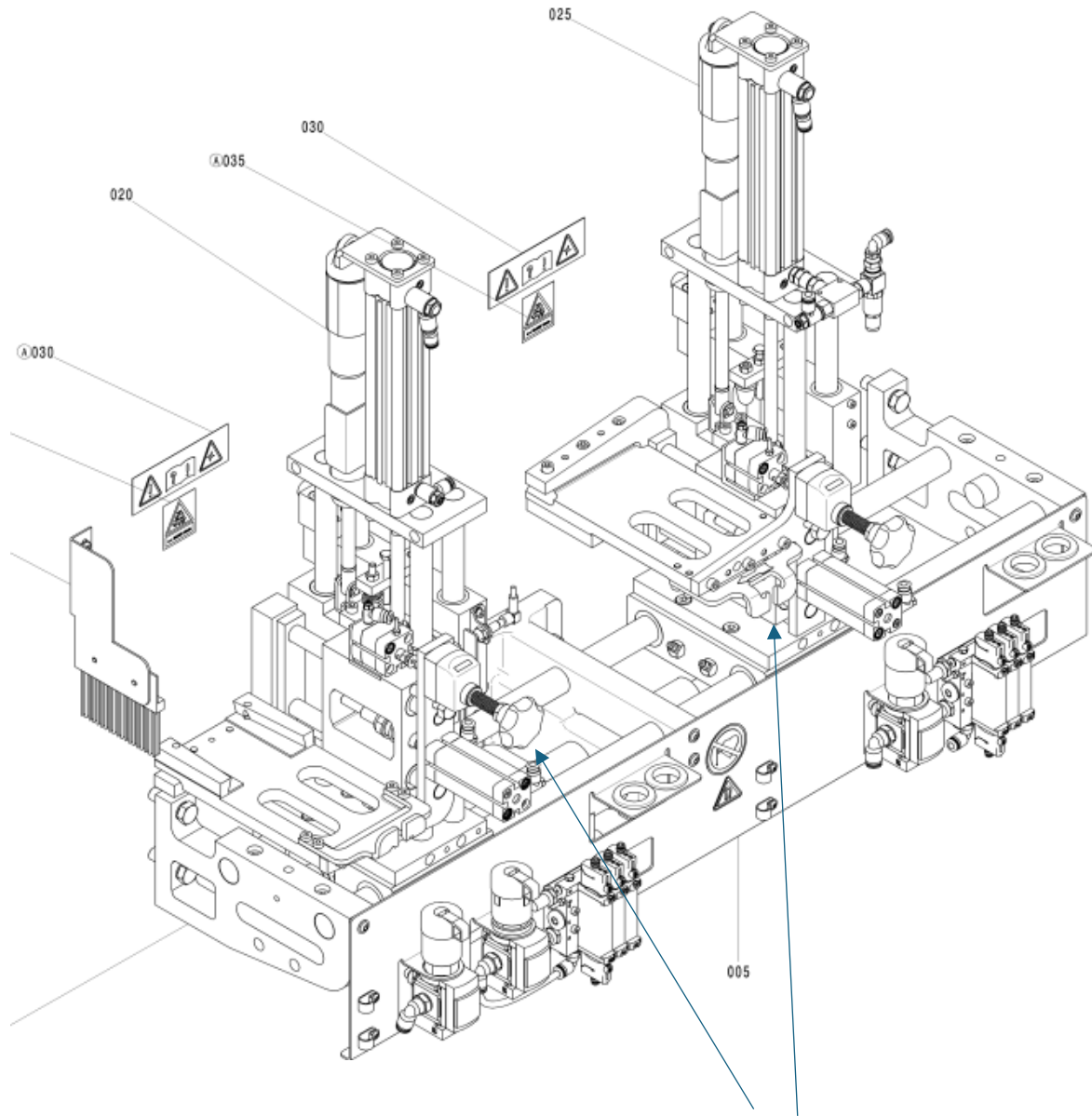

One Radius Cutter on Each Motor

Location:
Quantity on Machine:
Part Number:

Radius Scraping Unit MZ40
1 Scraper Ea / Top/Bottom
4-014-03-0688 & 4-014-03-0689

4-014-03-0688 - Top

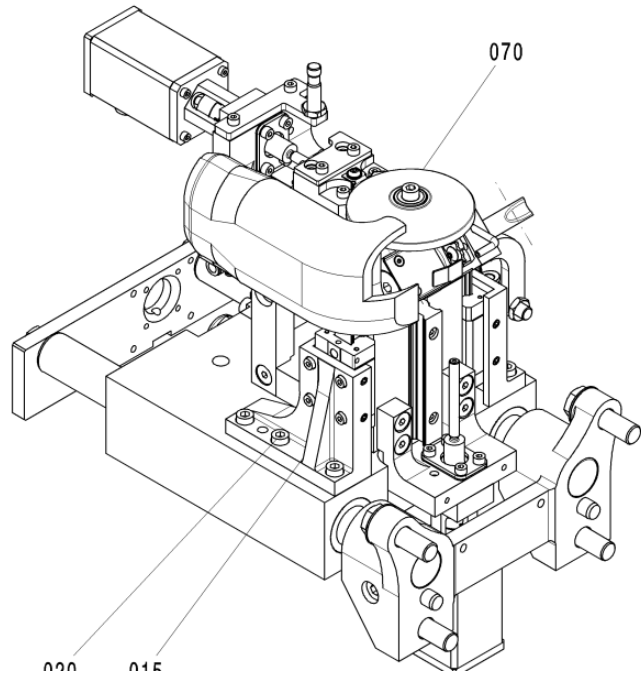

4-014-03-0689 – Bottom

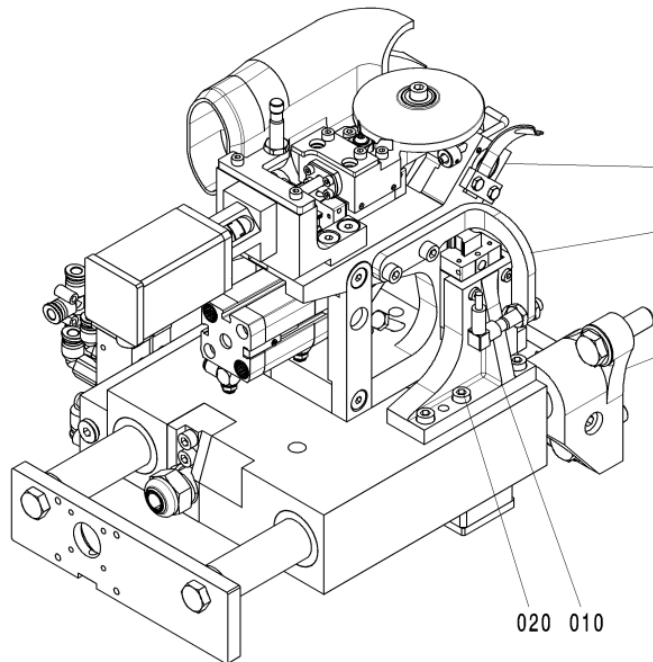

Location: Flat Scraping Unit ZF6410
Quantity on Machine: 1 Scraper Ea / Top/Bottom
Part Number: 4-014-03-0360 & 4-014-03-0361

4-014-03-0360 – Top

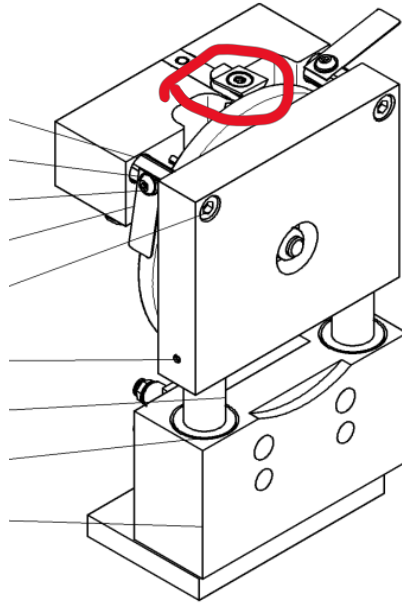

4-014-03-0361 – Bottom

